

STATE OF TEXAS           §  
   §  
COUNTY OF BRAZORIA   §

**RESOLUTION AND ORDER DECREETING THE ACQUISITION OF PROPERTY TO  
BE A PUBLIC NECESSITY AND AUTHORIZING THE ACQUISITION AND  
PAYMENT OF COMPENSATION**

WHEREAS, on the 8th day of April, 2025, at a meeting of the Commissioners Court of Brazoria County, Texas, sitting as the governing body of Brazoria County, upon motion of \_\_\_\_\_, seconded by \_\_\_\_\_, and upon record vote, passed \_\_\_\_\_ votes in favor, \_\_\_\_\_ votes opposed:

**RESOLUTION**

RESOLVED THAT WHEREAS, the Commissioners Court has received and reviewed the plans for a public project known as the County Road 400 Realignment Project, in Precinct 4, Brazoria County, Texas; and,

WHEREAS, Commissioners Court has determined that public necessity and convenience exists for a public project known as the County Road 400 Realignment Project, in Brazoria County, Texas, for the realignment of County Road 400 due to erosion of the Brazos River and the necessity of providing ingress and egress sufficient for emergency evacuation and emergency services during flooding events, in accordance with said plans, alignment, and tract identifications, which are made a part hereof as Exhibit 1 (the “Project”).

**ORDER**

NOW THEREFORE, IT IS ORDERED AND DECREED that the plans for the Project are approved.

IT IS FURTHER ORDERED AND DECREED that public necessity and convenience exists for the Project, including the acquisition of easements on the real property identified in

Exhibit 1, and that the Brazoria County District Attorney's Office be authorized and directed, and is hereby authorized and directed, to file or cause to be filed proceedings in eminent domain and to acquire thereby any easements for said purposes in the tract(s) which cannot be acquired by donation, dedication, or purchase.

IT IS FURTHER ORDERED AND DECREED that this Resolution and Order apply to any and all parcels of land that must be condemned for the Project, that the County Judge be authorized to sign any papers or agreements associated with closing the purchase(s); the District Attorney, County Engineer, County Clerk, County Auditor, and County Treasurer be authorized and directed to perform any and all necessary acts within their respective official duties toward the final acquisition of the tract(s) of land or interest(s) therein, together with the improvements, if any, within the Project, and the payment and compensation therefore.

**PASSED AND APPROVED** this \_\_\_\_\_ day of \_\_\_\_\_, 2025.

---

L.M. "Matt" Sebesta, Jr.  
County Judge

RIGHT-OF-WAY MAPS OF PROPOSED  
COUNTY ROAD 400 RELOCATION  
BRAZORIA COUNTY, TEXAS

SHEET INDEX

- LEGEND:
- FOUND MONUMENT
  - ⊗ PARCEL NO.

BEGINNING PROJECT  
STA. 9+00  
EQUALS STA 100+50 EXISTING  $\oslash$  CR 400  
N: 13,578,096.97 (GRID)  
E: 3,073,679.55 (GRID)

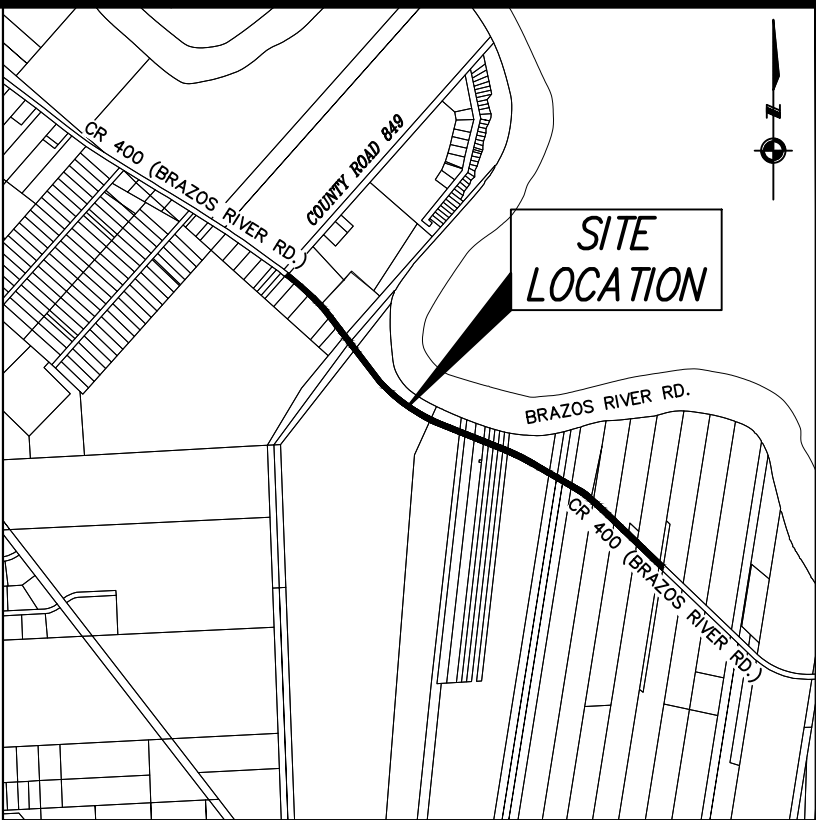
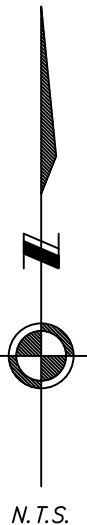

VICINITY MAP  
N.T.S. KEYMAP: 881R

- ABBREVIATIONS
- A.E.—AERIAL EASEMENT
  - DR.—DRIVE
  - DRWY C.E.—DRIVEWAY CONSTRUCTION EASEMENT
  - FND.—FOUND
  - B.C.C.F. NO.—BRAZORIA COUNTY CLERK'S FILE NUMBER
  - B.C.D.R.—BRAZORIA COUNTY DEED RECORDS
  - B.C.M.R.—BRAZORIA COUNTY MAP RECORDS
  - I.P.—IRON PIPE
  - I.R.—IRON ROD
  - RD.—ROAD
  - R.O.W.—RIGHT OF WAY
  - U.E.—UTILITY EASEMENT
  - VOL.—VOLUME
  - PG.—PAGE

- LEGEND:
- /// ASPHALT SYMBOL
  - ⊙ CLEANOUT
  - DOWN GUY
  - FIRE HYDRANT
  - GAS METER
  - ⊗ GAS VALVE
  - MAIL BOX
  - ⊞ PLANTER
  - POWER POLE
  - POWER POLE W/LT.
  - ⊙ SIGN
  - ⊙ STREET LIGHT
  - ⊙ TREE
  - ⊙ TREE—CREPE MYRTLE
  - ⊙ TREE—PINE
  - WATER METER
  - WATER VALVE
  - ⊙ PARCEL NO.

I HEREBY CERTIFY THAT THIS PLAT CORRECTLY REPRESENTS THE  
FACTS FOUND AT THE TIME OF SURVEY MADE ON THE GROUND UNDER  
MY SUPERVISION ON OCTOBER, 2022.

THIS SURVEY SUBSTANTIALLY COMPLIES WITH THE CURRENT TEXAS  
SOCIETY OF PROFESSIONAL SURVEYORS' STANDARDS AND  
SPECIFICATIONS FOR A CATEGORY 1B CONDITION 3 SURVEY AND THE  
CURRENT MINIMUM REQUIREMENTS OF THE PROFESSIONAL LAND  
SURVEYING ACT.

*Shahen Chowdhury* 7/14/23  
SHAHEEN CHOWDHURY, R.P.L.S.  
REGISTERED PROFESSIONAL LAND SURVEYOR  
STATE OF TEXAS, NO. 5858

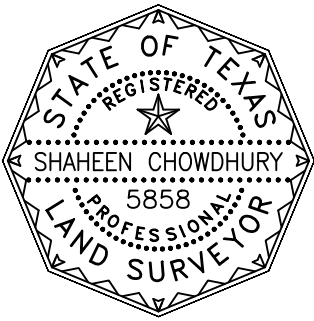

SHEET 1 OF 9

CR 400 (BRAZORIA RIVER ROAD) (80' WIDE)  
CONVEYED TO BRAZORIA COUNTY, TEXAS  
AND RECORDED UNDER:  
VOL. 751, PG. 266, VOL. 752, PG. 289-92,  
VOL. 773, PG. 338-342, VOL. 813, PG. 381,  
VOL. 813, PG. 410, VOL. 815, PG. 233-234,  
AND VOL. 816, PG. 682-683, B.C.D.R.

RECORDED UNDER  
SITUATED IN  
STEPHEN F. AUSTIN 7-1/3 LEAGUES GRANT,  
ABSTRACT NO. 20  
BRAZORIA COUNTY, TEXAS

**KUO**  
& Associates, Inc.  
Civil, Surveying, Engineering  
& Surveying  
10300 Westoffice Dr., Suite 800  
Houston, Texas 77042  
Tel: 713-975-8769, Fax: 713-975-0920  
www.kuoassociates.com  
TBPELS Engineering Firm Reg. No. F-4578  
TBPELS Surveying Firm Reg. No. 1007660

PROJECT: 22090  
DATE: 7/14/23  
DRAWN BY: TQT  
CHECKED BY: SC

NOTES:

- THIS MAP WAS PREPARED WITH THE BENEFIT OF A CURRENT LIMITED TITLE CERTIFICATE PREPARED BY COURTHOUSE SPECIALISTS; JOB NO. 2240116A, 2240116A-2, 2240116A-3, 2240116A-4, 2240116A-5, 2239598A-6, 2239598A, 2239598A-2, 2239598A-3, 2239598A-4, 2239598A-7, 2239598A, 2239598A-9, ; EFFECTIVE DATE: AUGUST, 2022 AND COUNTY ROAD 400 RESEARCH.
- ALL BEARINGS AND DISTANCES ARE BASED ON TEXAS STATE PLANE COORDINATE SYSTEM, SOUTH CENTRAL ZONE, NAD83 (CORS96).
- THE COORDINATES SHOWN HEREON ARE TEXAS SOUTH CENTRAL ZONE NO. 4204 STATE PLANE GRID COORDINATES (NAD83).
- EXISTING UNDERGROUND UTILITY INFORMATION (TYPE, SIZE & OWNERSHIP) ARE SHOWN APPROXIMATELY BASED ON THE AVAILABLE RECORD DRAWINGS AND FIELD VERIFICATION (WHERE FEASIBLE) WITHOUT PROBING AND EXCAVATION; NO WARRANTY IS MADE AS TO THE ACCURACY OR COMPLETENESS OF UTILITY LOCATION SHOWN ON THE DRAWING. CAUTION SHOULD BE EXERCISED WHEN EXCAVATING OR BORE AND JACKING IN THE VICINITY OF UNDERGROUND UTILITIES. OWNERS OF THE UTILITIES SHOULD BE NOTIFIED PRIOR SUCH ACTIVITIES. CALL UTILITY COORDINATING COMMITTEE AT 713-223-4567, AT LEAST 48 HOURS PRIOR TO EXCAVATING IN THE STREET RIGHT-OF-WAY.
- ACCORDING TO F.I.R.M. MAP NUMBER 48039C0595K FOR BRAZORIA COUNTY, TEXAS AND INCORPORATED AREAS (MAP REVISED DECEMBER 30, 2020). THE SUBJECT AREAS IS LOCATED IN ZONE 'AE', SPECIAL FLOOD HAZARD AREAS SUBJECT TO INUNDATION BY THE 1% ANNUAL CHANCE FLOOD EVENT; BASE FLOOD ELEVATION DETERMINED.
- TREES WITHIN WOODED AREAS ARE NOT SHOWN.

EXHIBIT 1